

NOTES

1. THIS DRAWING SHOULD BE USED FOR CONSULTATION ONLY.
2. DO NOT SCALE FROM THIS DRAWING.
3. INTERMEDIATE COLUMNS NOT SHOWN FOR CLARITY.
4. EXTENT OF FENCING/NETTING IS TO BE FINALISED FOLLOWING CONSULTATION WITH NEATH PORT TALBOT COUNTY BOROUGH COUNCIL.

KEY

- AREA TO BE NETTED TO MAINTAIN PUBLIC ACCESS BELOW.
- AREA TO BE SECURELY FENCED TO PREVENT PUBLIC ACCESS.
- AREA PROPOSED FOR NETTING - SWTRA TO LIAISE WITH LANDOWNER

ISSUE/REVISION

NO.	DATE	DESCRIPTION
A	16/06/2021	FIRST ISSUE
I/R	DATE	DESCRIPTION

PROJECT

SOUTH WALES TRUNK ROAD AGENT (SWTRA)



CLIENT

SWTRA
12A LLANDARCY HOUSE
LLANDARCY
THE COURTYARD
NEATH PORT TALBOT
SA10 6EJ
0300 123 1213 TEL
WWW.SWTRA.CO.UK

SHEET TITLE

M4 PORT TALBOT
DYFFRYN
FENCING AND NETTING ARRANGEMENT

CONSULTANT

AECOM
THE COLMORE BUILDING
BIRMINGHAM
B4 6AT
0121 710 1100 TEL
0870 048 7089 FAX
WWW.AECOM.COM

SHEET NUMBER

60522246-CTI-001D-DYF-DWG-0301

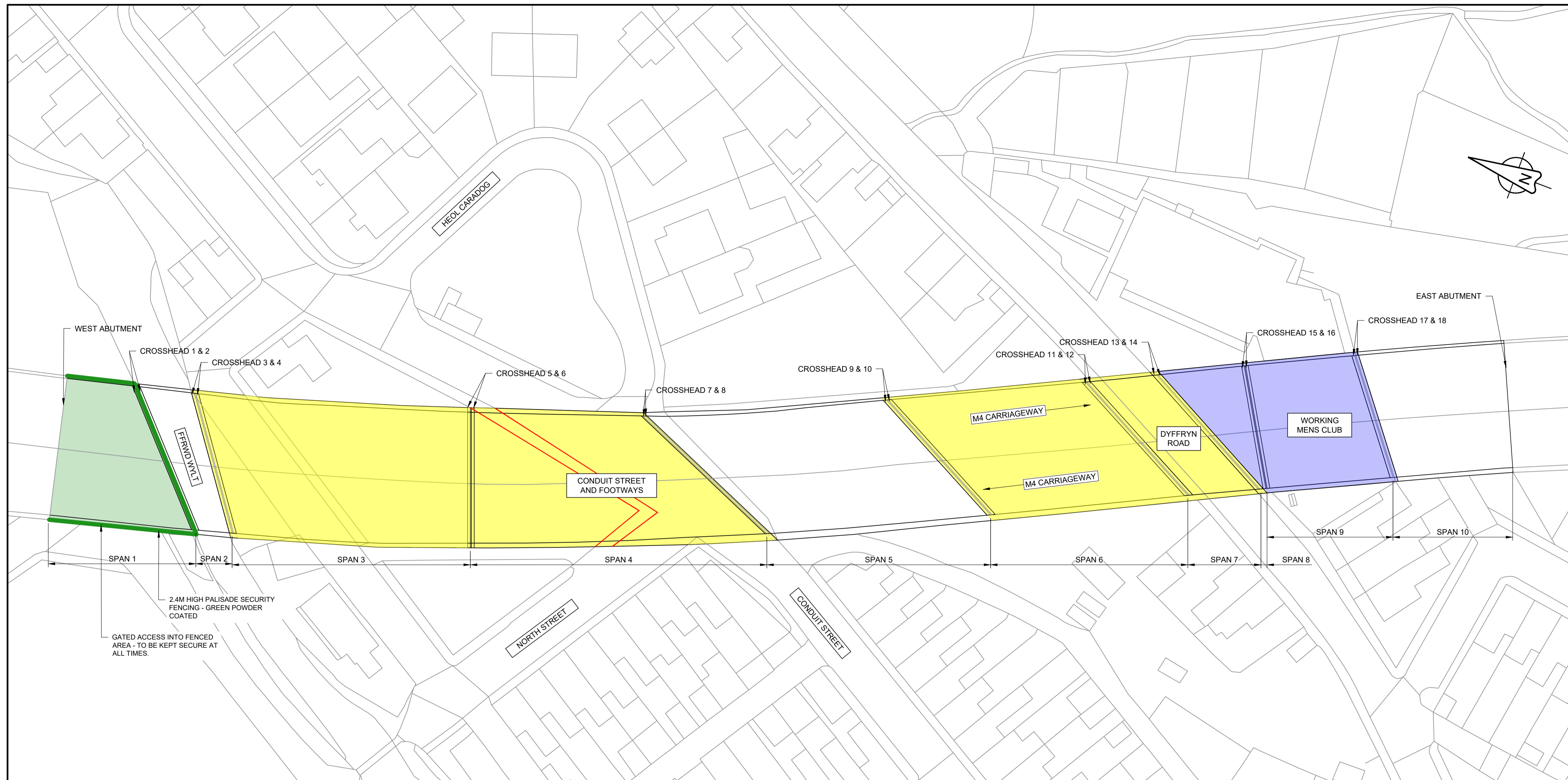

PLAN
NTS



FIGURE 1: GENERAL VIEW OF NORTH ELEVATION.



FIGURE 2: GENERAL VIEW OF SPAN 1 WITH PROPOSED FENCING.



FIGURE 3: GENERAL VIEW OF SPAN 4 WITH PROPOSED NETTING.



FIGURE 4: GENERAL VIEW OF SPAN 7 WITH PROPOSED NETTING.